

&
AB
lightdesignagency



WHO WE ARE

Since its establishment in 2005, our agency has set the objective of integrating light, specifically artificial lighting, into the creative process of architectural design. The goal is to add an additional dimension to space while respecting technical and energy constraints. A close collaboration with architects, designers, and engineers allows us to optimize solutions and establish the connection between aesthetics and technology. Our agency strives to find innovative solutions for each project.

Light becomes visible in interaction with matter. Beyond «useful» light, it reveals space, textures, colors, etc. For us, this requires a specific approach to each project. This may involve the development of a specific luminaire if the relevance of such an approach is confirmed. In other cases, a reinterpretation or adaptation of an existing lighting fixture or standard luminaire on the market is used. Our approach is neutral; we work with all lighting fixture suppliers as long as their products meet our requirements.

Evelyne Aebischer, a graduate architect from the Zurich Polytechnic School in 1997, specialized in lighting shortly after completing her studies. She worked for several years in a lighting fixture manufacturing and supply company, acquiring technical knowledge in lighting. She also went through all stages in the process of designing and manufacturing luminaires, allowing her to design luminaires specific to different projects today.

Philippe Bovigny, trained as a draftsman-electrician, deepened his technical knowledge in various electrical engineering offices, enabling him to interact with technicians in the field today. He underwent additional training as a project manager and worked for several years for a lighting manufacturer and supplier. In 2005, Evelyne Aebischer and Philippe Bovigny combined their knowledge and skills to create the lighting design firm **Aebischer & Bovigny**.



THE TEAM

Evelyne Aebischer *Co-founder, EPFZ architect, SIA member -*

Teaching at the Lausanne Polytechnic School (EPFL) in the «Space and Light» unit since 2009

Philippe Bovigny *Co-founder, Electrical Technician, and Project Manager at Ifcam*

Anna Meloyan *Architect, Yale University, Head of the Los Angeles agency*

Emilien Jaury *Lighting designer and product designer, ECAL Design for Luxury and Craftsmanship, ESDAMAA Product Design*

Thuy Nhi Ho *Lighting designer and interior architect*

Aebischer & Bovigny

lightdesignagency

Avenue du Valentin 30

1004 Lausanne

Switzerland

T +41 213209648

E: eclairage@aebischer-bovigny.ch

HISTORIC BUILDINGS



Former Prefecture of Versoix, Switzerland

The restoration of historical structures is a vital act of preserving our rich history and culture. Artificial lighting assumes a pivotal role in this endeavor, contributing significantly to accentuating and safeguarding these architectural treasures. Care must be taken during the renovation process to avoid any alterations or damage to these historical buildings. The impact of artificial lighting varies depending on the setting, with different illumination requirements in workspaces compared to areas dedicated to reflection or religious practices.

Lighting serves as a versatile tool to elevate architecture, create distinct atmospheres, and ensure optimal lighting quality for the intended use of the space.

Modern LED sources, known for their flexibility, allow for great creativity without compromising on light quality or energy efficiency. Each renovation project presents unique challenges, and solutions often need to be tailored accordingly. In collaboration with renowned suppliers and skilled craftsmen, we explore possibilities specific to each project to find the best possible solution.



Following on-site prototype testing, the decision was made to incorporate two light strips for improved light distribution on the ceiling. One strip is positioned at the top of the woodwork, diffusing light upwards, while the other is mounted on a brass profile, diffusing light horizontally.

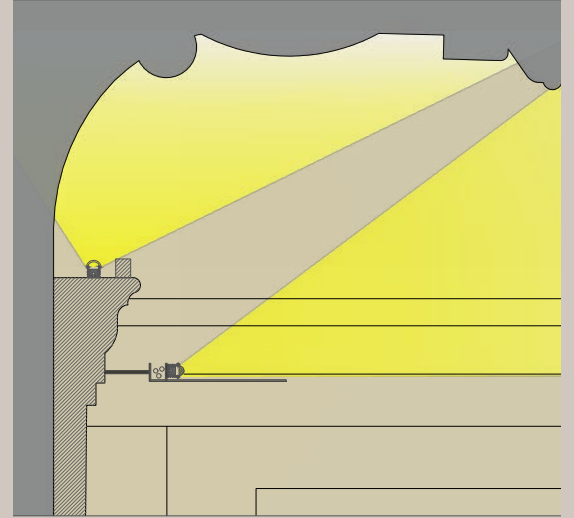

The Cantonal Hotel of Fribourg, Switzerland

The Cantonal Hotel of Fribourg stands as one of Switzerland's oldest and remarkably preserved town halls, proudly inaugurated on September 30, 1522. As a venerable symbol of power and history, it has witnessed numerous transformations over the years, including the addition of the Concierge building and the Guardhouse in 1732, with further expansions in 1782.

The incorporation of indirect lighting around the room effectively guarantees ample illumination for users. LEDs discreetly positioned on a brass plate and securely affixed to the woodwork render the installation nearly imperceptible.



Across the different levels of the building, the spaces and materials vary significantly. The lighting concept has been tailored to accommodate these differences while maintaining functionality and subtlety.





Abbey of Maigrange in Fribourg, Switzerland

Nowadays, many churches are in need of a lighting system upgrade. Worship spaces demand increased brightness, yet existing fixtures are no longer adequate. Moreover, certain light sources like incandescent, halogen, and fluorescent are no longer permissible due to energy efficiency and sustainability concerns. We address parish requests directly or collaborate with architects and heritage managers based on the client's desired level of involvement. We conduct a thorough analysis of the situation and offer diverse approaches and tailored solutions based on specific needs.

Our approach is neutral; we provide advice on lighting fixtures from various manufacturers, fostering healthy competition. We aim to minimize interventions in electrical installations by maximizing the utilization of existing power points. The selection of a lighting and light management system that avoids additional wiring simplifies the electrical setup. This innovation relies on Bluetooth technology, offering straightforward and user-friendly programming, controllable via wireless switches, user-preferred positions, tablets, or smartphones.



Church of Sorens

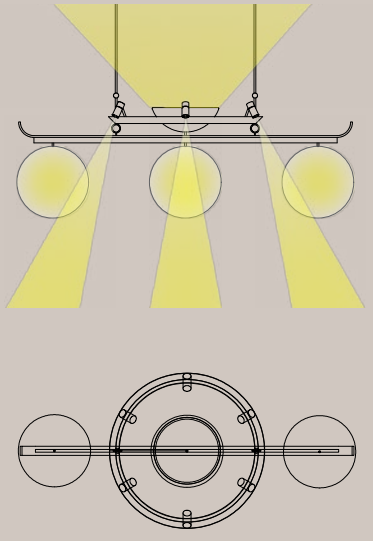

Church of Saint-Rédempteur, Lausanne, Switzerland

Church of Saint Rédempteur, Switzerland

In collaboration with architect Eric Frei, we conceptualized a circular structure with a diameter of over 3 meters. This design incorporates directional spotlights and indirect lighting, providing versatile options for managing both direct and indirect light intensities. The setup offers multiple lighting scenarios tailored to specific needs.

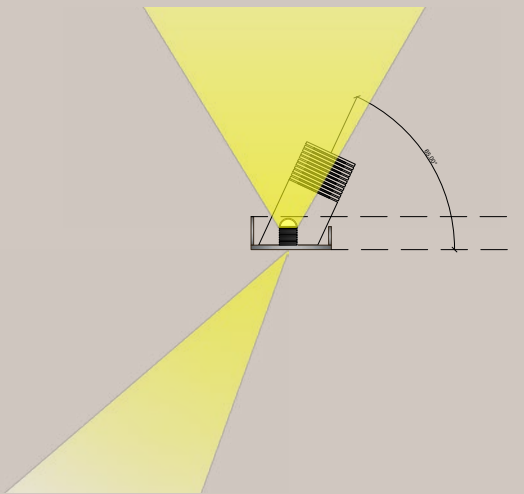

Church of Sorens, Switzerland:

The Sorens parish approached us for the modernization of its church lighting, focusing solely on adapting and updating the lighting without any other planned renovations.

Users expressed their desire to keep the chandeliers. In the 1980s, these chandeliers had been modified, and the globes were replaced with acrylic glass cylinders. We decided to revert to diffusing globes and increase the power of the light sources.

Additionally, we added a ring with six directional spotlights to balance the distribution of light between the chandeliers. Indirect lighting was integrated into the 'cup' to illuminate the ceiling. A local artisan was able to craft a brass ring, and the chandeliers were restored.

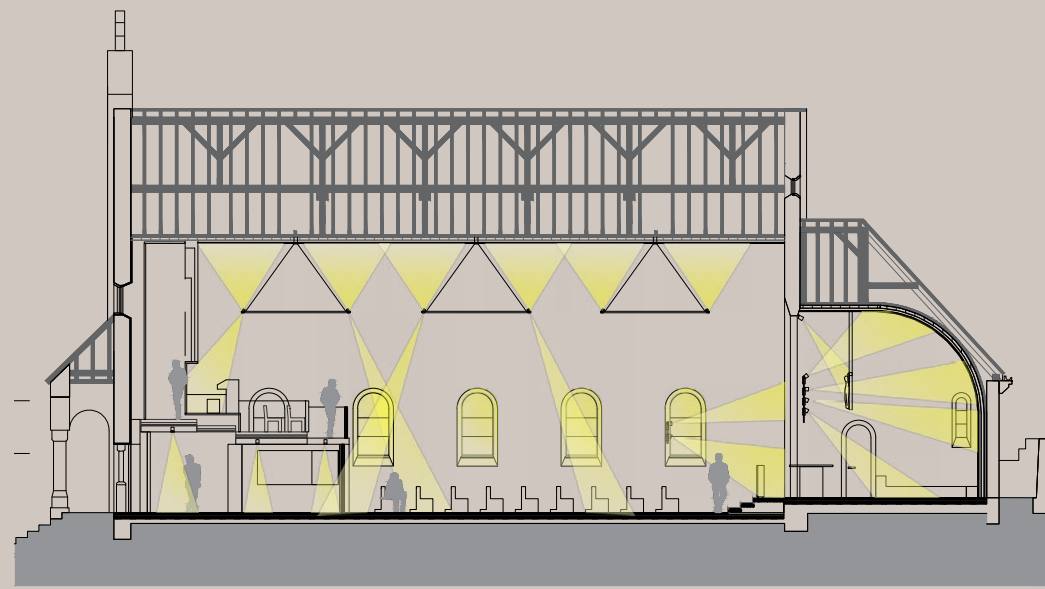



Flagship store Vacheron Constantin in New York

Drawing on extensive experience, we've cultivated substantial expertise within the retail sector. Our collaborative efforts span international projects, involving close partnerships with architects and diverse local stakeholders.

Our focus prioritizes visual comfort and light quality, aiming to elevate the customer experience and accentuate products. The lighting concept assumes a pivotal role in affirming the identity of the space and the brand.

Our commitment to each project is comprehensive, covering various facets, including general lighting, seamless integration into furniture, storefront studies, the incorporation of decorative luminaires, and specialized studies for staging facades.

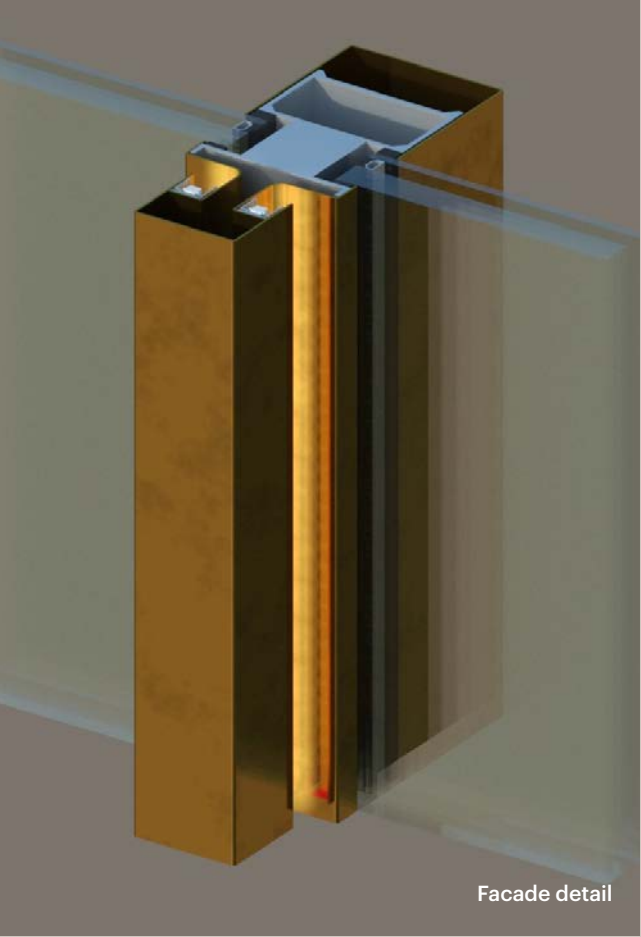

In collaboration with local architects, we developed a holistic concept that ensures an ideal equilibrium between essential technical lighting to showcase watches and ambient lighting from features like light cornices and ornamental fixtures such as wall sconces and pendants. In the entrance hall, we incorporated adjustable spotlights into light cornices for enhanced flexibility.

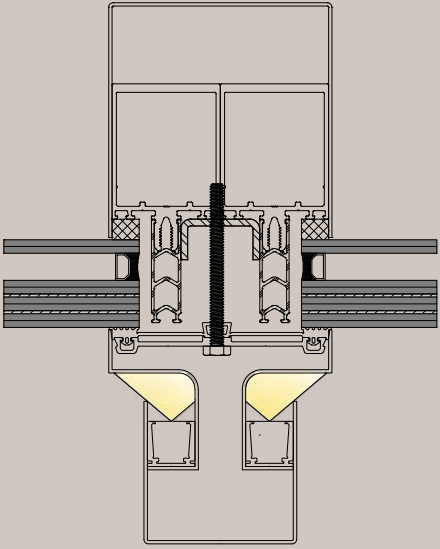
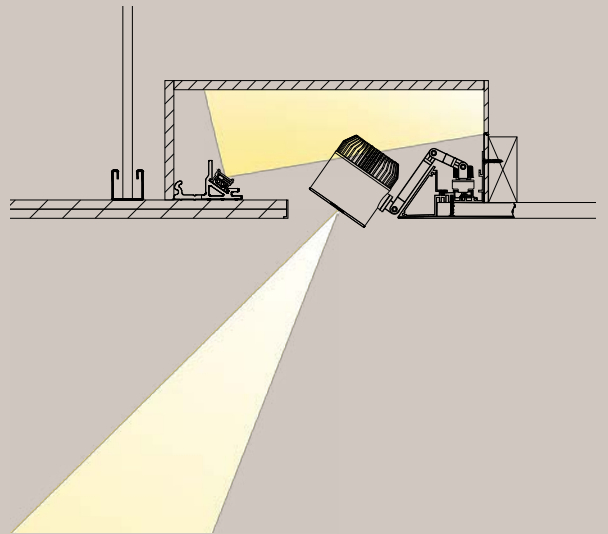

Vacheron Constantin NYC - Facade :

In instances demanding specialized expertise, we craft simple mock-ups, enabling clients to visualize the outcome before the development of a more advanced prototype and the final implementation.

For example, in addressing the flagship's facade, we initially constructed a model of the profiles, which were subsequently extruded and embedded with linear LEDs.

The meticulous integration of light into the profile ensures the elimination of unwanted reflections of the light lines on the glazing.



OUTDOOR



Town Hall Square in Sierre, Switzerland

Renens Train Station Squares and Footbridge:

The challenge for this project was to create an inviting environment for users, eliminating the boundary between the road and the surroundings of the meeting area, and establishing a welcoming atmosphere on both the north and south squares.

The lighting plays a key role in delineating the space's purpose and promotes a sense of consideration among motorists for other users in the area.



In today's context and looking ahead, addressing light pollution is increasingly a top priority. This is reflected in the adoption of light sources featuring directed beams, the use of wildlife-friendly color temperatures, and a concerted effort to minimize light intensity for energy-saving purposes.

Considerations include meeting illumination and visibility standards for pedestrians, motorists, as well as sustainable modes of transportation.

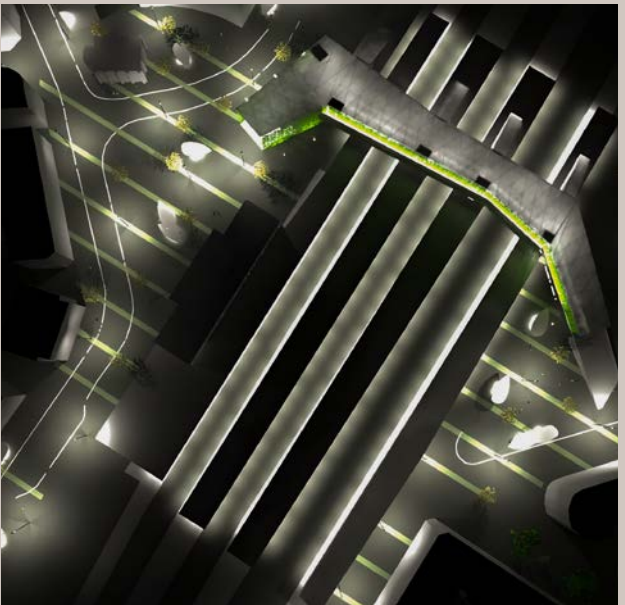

The interconnection of spaces was realized through light, incorporating lighting seamlessly into the architecture. Luminous lines were integrated into the structure of the footbridge.





Rhone 30 in Genève



Iconic structures merit special attention, enabling the establishment of landmarks and a unique urban identity.

The incorporation of lighting into the architectural design is executed with subtlety, considering the surrounding environment. The objective is to delicately accentuate architectural elements while upholding visual harmony within the neighborhood or the broader cityscape. This approach enhances the visual allure of iconic buildings without sacrificing aspects related to energy efficiency, environmental lighting quality, and ecological considerations.



Miroiterie, Lausanne:

The lighting intensity is customizable, providing the flexibility to play with light levels by adjusting them up and down. This feature imparts a dynamic quality, creating the illusion that the building is pulsating or breathing.



Saint-George Center, Geneva:

An invisible light source in the form of integrated luminous lines embedded into the architecture reveals colors and textures. Employing white light on a colored facade introduces a captivating visual dimension, creating a nuanced interplay of light that highlights architectural elements and emphasizes color and texture intricacies. This understated lighting strategy plays a crucial role in seamlessly integrating the light source into the building's overall aesthetics.

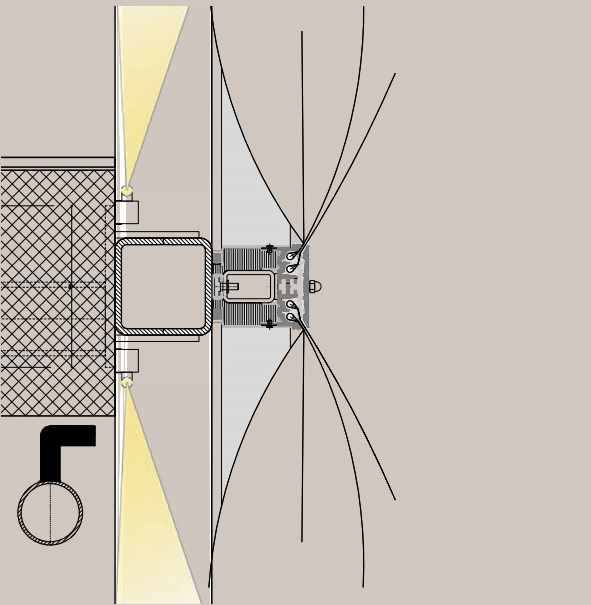

PRIVATE RESIDENCES



Private residence in Corseaux, Switzerland

In private residence projects, addressing clients' aesthetic preferences is crucial for crafting an atmosphere that resonates with their unique tastes. Modulating lighting provides the ability to create both contrasting and diffused atmospheres, catering to various moods and enhancing the overall experience in the residence.

The development of different lighting scenarios facilitates the adaptation of lighting to diverse usage moments, ensuring a comprehensive and enriched living experience. To achieve this flexibility seamlessly, we recommend the integration of intelligent lighting systems and automated controls.



Villa San Remo, California:
In collaboration with the interior designer, we successfully created a warm atmosphere.





Béthusy College in Lausanne, Switzerland



We design customized projects for schools, colleges, and nurseries, seamlessly integrating our concepts into the architecture. Our approach combines aesthetics and functionality, ensuring compliance with technical regulations and standards governing lighting, illumination levels, uniformity, energy efficiency, and glare prevention.

Each of our proposals reflects our dedication to constructing educational spaces where design seamlessly coexists with technical requirements, fostering environments that are conducive to learning and development.



Bethusy College:

Informed by the wooden construction typology, our lighting concept for this project seamlessly integrates luminous lines into various spaces. In classrooms, these lines are installed between the wooden beams, aligning with their orientations. In circulation areas, they become part of the ceiling, providing guiding illumination for users throughout their journey.





Residence Les Campanules in Vernier, Switzerland

For elderly care residences, our main objective is on establishing a pleasant, comfortable, and safe environment. This is achieved through the incorporation of decorative lighting with warm materials.

The integration of technical lighting plays a crucial role in providing ample illumination, particularly for visually impaired individuals. This balance between aesthetics and functionality helps make these spaces welcoming and tailored to the specific needs of the residents.



Opting for a combination of direct and indirect lighting, we aimed to modulate the atmospheres, offering the flexibility to adjust the light intensity as needed. Direct lighting emphasizes specific points, drawing attention to particular elements or designated areas, while indirect lighting produces a gentle ambient glow that enhances the overall atmosphere of the space.

Residence Les Campanules in Vernier:

In the design of the lighting, we took into account the constraints of the users. This approach aims to ensure that the lighting meets the diverse expectations of visitors, while adhering to standards and ensuring visual comfort for everyone.



HOSPITALS AND CLINICS



In the realm of hospitals and clinics, various specific constraints demand careful consideration, especially concerning illumination levels and glare. Maintaining high standards is imperative to ensure optimal working conditions for medical staff and the comfort of patients.

Simultaneously, the lighting must exude a hospital character, crafting a luminous ambiance that is both effective and pleasant for patients. The goal is to foster an environment that instills confidence and serenity while optimizing the functionality of medical spaces. Tailored lighting solutions, including dimmable fixtures, utilization of natural light sources, and technologies enhancing occupants' well-being (such as color temperature adjustment), may be explored. An integrated approach, one that considers both technical requirements and patient comfort, contributes to the creation of more welcoming hospital environments conducive to healing.



Cery Hospital:

In this project a cornice artfully mimics skylights, providing simple and unobtrusive lighting designed for the well-being of patients.

Utilizing concealed luminaires embraces a discreet approach, ensuring effective lighting without visible light sources. This discretion plays a pivotal role in creating a tranquil atmosphere and maintaining a streamlined aesthetic.

Pendant lights have been seamlessly incorporated along the spiral staircase, introducing a distinctive visual element to the space. Beyond their lighting functionality, these pendants play a significant role in enhancing the overall aesthetic design of the project.

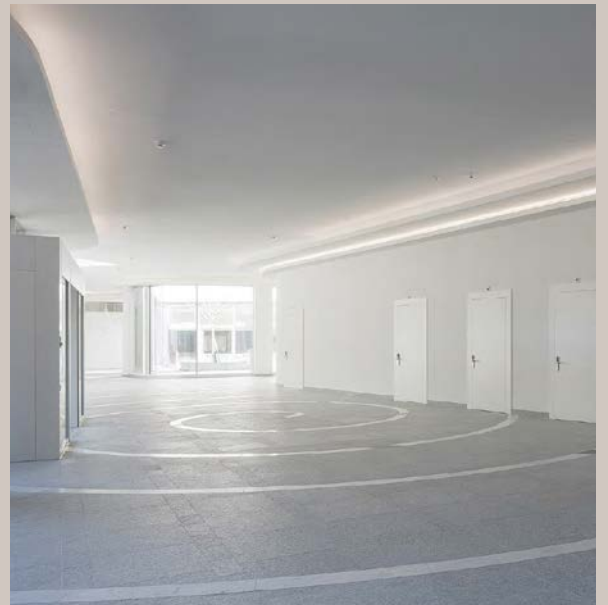

OFFICES AND ADMINISTRATIVE BUILDINGS



Raiffeisen of l'Étang, Switzerland



Today, administrative buildings and office spaces are evolving into open configurations, transforming into workplaces that incorporate meeting and collaborative zones. Lighting must adjust to these novel demands and the adaptability of spaces, taking into account lighting management. Fine-tuning the color temperature of light is essential to meet specific demands, ensuring visual comfort with well-illuminated wall surfaces. All of these considerations must be met while adhering to constraints related to illumination levels and glare.



Roldeco Offices in Crissier:

For this project, we chose a combination of discreet low-luminance fixtures, diffuse luminaires, and decorative lighting. Luminous lines were arranged around the skylights to simulate natural light during the night.





Historic Museum of Lausanne, Switzerland

In exhibition spaces, it is imperative to constantly adapt to artworks, whether to showcase them or present them as faithfully as possible. It is essential to adhere to technical constraints such as the quantity of light and color temperature.

Museums are often spaces where a high degree of lighting flexibility is necessary as they need to continuously adjust to new exhibitions. The frequent use of diffused or contrasted lighting contributes to creating specific atmospheres based on the exhibited artworks.

A simple lighting management system allowing for variable light intensity is crucial to protect the artworks. This ability to adjust lighting according to specific needs ensures not only the preservation of the artworks but also an optimal presentation, reflecting the artistic intention of each exhibition.



For this project, we opted for diffused lighting, specifically tailored to the presented objects. This approach aims to highlight the objects based on their shapes, dimensions, and materials. Diffused lighting provides a uniform distribution of light, avoiding harsh shadows and delicately emphasizing the details of the objects.

This technique optimizes the presentation of exhibited pieces, accentuating their features harmoniously and creating an atmosphere conducive to the appreciation of the artworks.

The Historical Museum of Lausanne:

The challenge was to restore a certain coherence to the Historical Museum of Lausanne (MHL), a heterogeneous space where the old and the new harmoniously articulate. The new scenography, whose unified material expression guides the visitor through the permanent exhibition, stands out from the building to reveal it further. In a subtle balance, space, work, and scenography merge.



CONCERT VENUE



Music Club, le Port Franc in Sion, Switzerland

Performance venue, L'Usine à Gaz, Nyon:

In the performance hall, we prioritize low-luminance fixtures for general lighting to preserve the darkness of the venue. Technical management is handled by the venue's control booth, allowing for precise control.

Meanwhile, the relaxation areas, cloakroom, and bar are illuminated with carefully chosen fixtures to foster a warm and welcoming atmosphere.

The objective is to strike a balance between creating a pleasant ambience and ensuring the necessary functionality for these spaces.



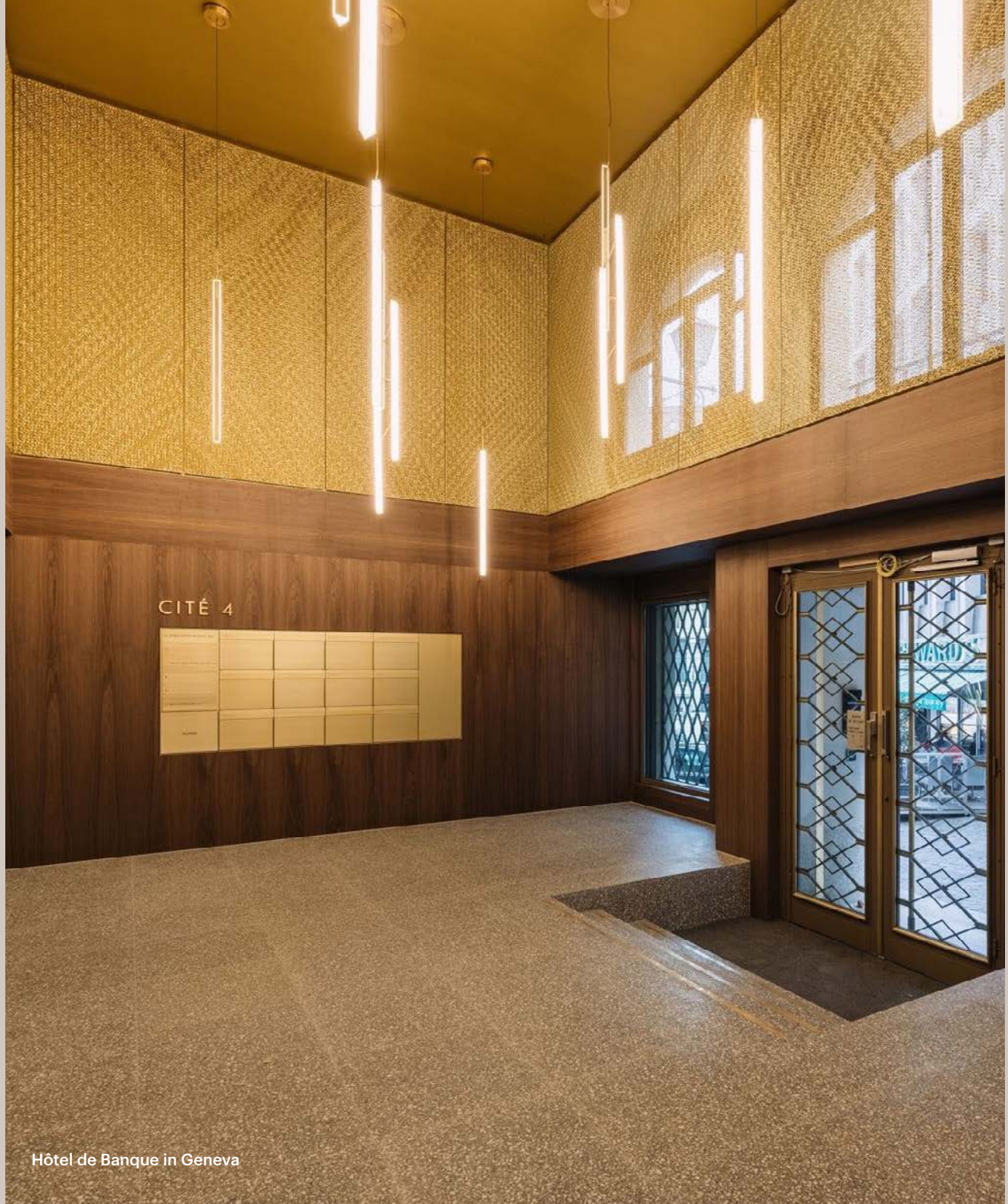

Hôtel de Banque in Geneva

SELECTION OF ONGOING PROJECTS

UIT Geneva *Christian Dupraz architects, Geneva*

Residential buildings in Eaux Vives *Brauen et Wälchli Architects, Lausanne*

Cultural center of Chatelaine *CCJV office architects S.L.P, Madrid*

Latin College in Neuchâtel *Chablais Fischer architects, Estavayer-le-lac*

Cantonale Library of Fribourg *butikofer de oliveira architects, Lausanne*

Swiss Embassy in Beijing *Brauen & Wälchli architects, Lausanne*

Swiss Embassy in Addis Abeba *Office Leibundgut Bühler Hartmann, Zürich*

Flagship store Vacheron Constantin in Beverly Hills *Vacheron Constantin, Geneva*

Patek Philippe in Beverly Hills *Patek Philippe, Geneva*

Castle of Gruyères *State of Fribourg*

Villa Verts Pommiers in Corseaux *Brauen & Wälchli architects, Lausanne*

Cordeliers church in Fribourg *Direct Mandate*

Sport center and Pervenches School in Carouge *Atelier March Architects, Geneva*

Silver Tower in Bienne *Concept Consult, Lausanne*

EMS Château de Corcelles *Stoa Architects, Neuchâtel*

CO Givisez *Atelier March Architects, Genève*

Cour de Gare, concert hall, Sion *Bonnard Woeffray Architects, Monthey*

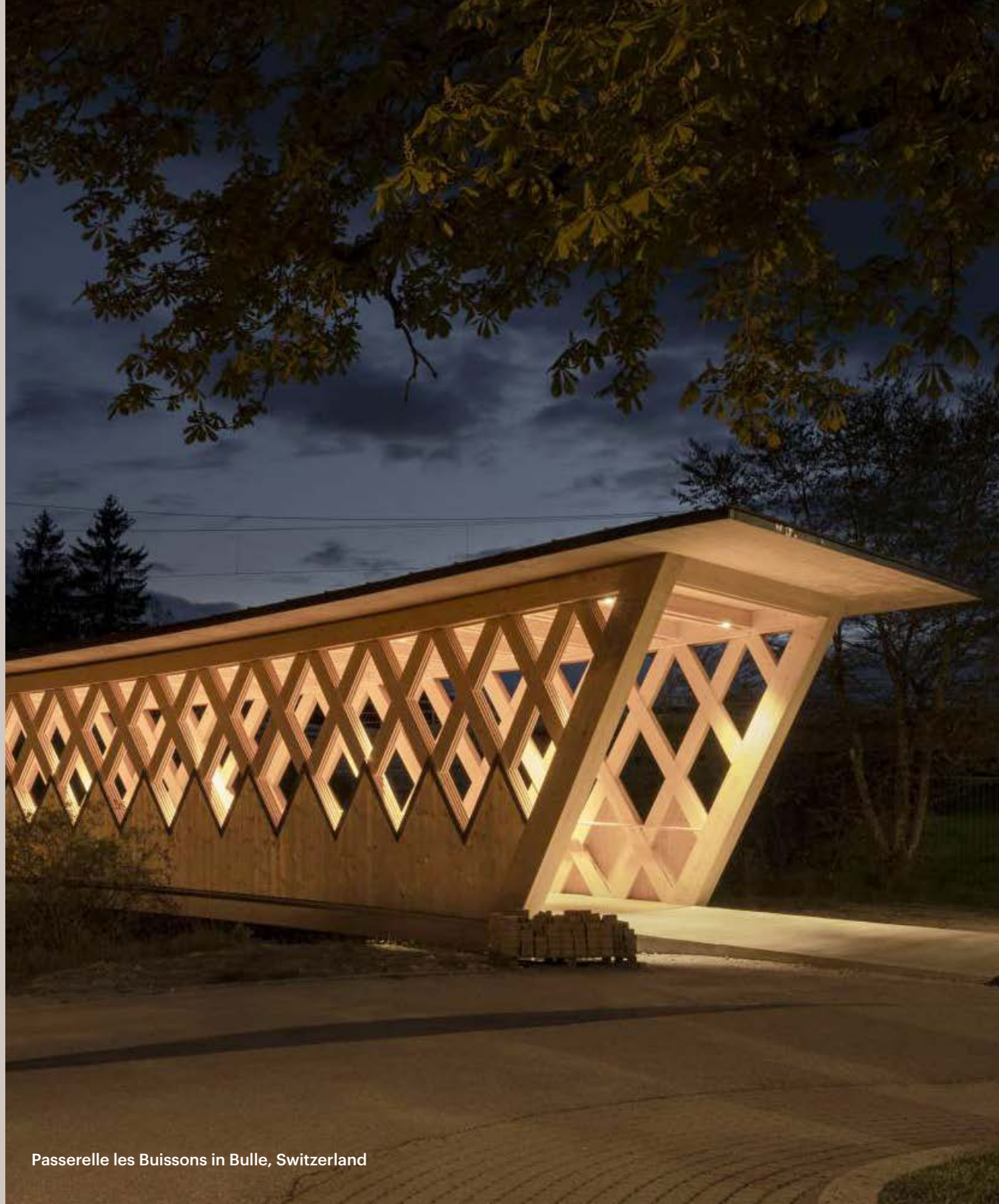

Passerelle les Buissons in Bulle, Switzerland

SELECTION OF COMPLETED PROJECTS

OFFICES AND ADMINISTRATIVE BUILDINGS

CIO Headquarters in Lausanne *Brauen et Wälchli Architects, Lausanne*

Roldeco office in Crissier *Boschetti architects, Lausanne*

St-Georges Center, Geneva *Sauerbruch et Hutton Berlin avec SPG et Fossati architects, Geneva*

La Commanderie in Fribourg *Andrey-Schenker-Sottaz architects SA, Fribourg*

Extension of the Rolex headquarters in Bienne *Gebert Architekten, Bienne*

Raiffeisen of l'Étang *Zysman Architects, Lausanne*

Private management company, Headquarters in Geneva *Anderegg et Rinaldi architects, Carouge*

Vaudois Sport House in Leysin *Mann Capua Mann architects, Lausanne*

Raiffeisen in Chasseral *Sollberger Bögli Architekten AG, Bienne*

Piaget Manufacture, Plans les Ouates *Studer architects, Neuchâtel*

Beezi, Work space *Ris + partenaires Architectes, Geneva*

Hotel Cantonal in Fribourg *Aeby Aumman Emery Architects, Fribourg*

Hotel de Banque in Geneva *GM Architects / PSP, Geneva*

OUTDOOR

Historics monuments of Romont *City of Romont*

Squares and footbridges of the train station Rayon vert in Renens *farra zouboulakis & associés architects urbanistes SA et l'Atelier du Paysage, Lausanne*

Esplanade of CHUV in Lausanne *Luscher architects, Lausanne*

Square of the Town hall in Sierre *Collectif architects in Sierre and City of Sierre*

Lighting plan for the center of Sierre *actescollectif architects in Sierre and city of Sierre*

St. Felix Square in Saxon *savioz fabrizzi architects, Sion*

Morat Road Axis *City of Fribourg, Architecture department*

Poy Bridge in Fribourg *City of Fribourg, Architecture department*

Buissons Footbridge *RBCH Architects, Bulle*

Parc of l'Étang *Apaar, Geneva*

SELECTION OF COMPLETED PROJECTS

SHOPS

SEN SU Pharmacy, Lausanne *Ferrari architects, Lausanne*

Petit Prince Bakery, Lausanne *Concept Consult architects, Lausanne*

Mövenpick Ice Cream, Geneva, Zürich, Moscou *Concept Consult Design, Lausanne*

Pavillon Cailler à Broc *Concept Consult Design, Lausanne*

C38 in Passific Palissade *Montalba Architects, Los Angeles*

Boutiques Vacheron Constantin Worldwide : New York, Dubai, Los Angeles Zhenzhu, Macau, Pekin, Tokyo, Seoul, *Vacheron Constantin, Geneva*

Bahamas, Dubai, Paris, Shenyang...

Boutiques Patek Philippe : Moscou, Rome, Vienne, Beverly Hills *Patek Philippe, Geneva*

Boutique Percing et Tatoos Giada Ilardo *Studio Forma, Zürich*

CONCERTS VENUES

Grandson's Large Hall *Boschetti architects, Lausanne*

Cultural Center of Courtepin *Zamparo et Milan architects, Fribourg*

Arsenic Theater, Lausanne *Pont 12 Architects, Lausanne*

Kongresshaus Biel *City of Bienne, Architecture Department*

Dedicated venues for contemporary music, Le Port Franc in Sion *savioz fabrizzi architects, Sion*

Concert Venue of Usine à Gaz in Nyon *Esposito + Javet architects, Lausanne*

MUSEUMS

Contemporary Art Gallery, Lausanne « Galerie d'(A) » *Frei Rezakhanlou architects, Lausanne*

Museum of art brut, Lausanne *Collection of art brut*

Barbier-Mueller Museum, Geneva *Geneva private Management Company*

Historical Museum of Lausanne *Brauen et Wälchli Architects, Lausanne*

SELECTION OF COMPLETED PROJECTS

PRIVATE RESIDENCES

Ours Chalet in Crans-sur-Sierre *Bonnard & Woeffray architects, Monthey*

Villa in Clarens *Erale Sa*

Residence in Vevey *BD Architecture, Saint-Légier*

Villa in Collogny *OVA architectes, Genève*

Villa in Corseaux *Brauen & Wälchli architectes, Lausanne*

Villa in Chéserey *Bureau Sekkiou Architectes, Nyon*

Théodore Flournoy Apartment, Geneva *SPG Geneva*

La Becque, La Tour-de-Peilz *Pont 12 architects, Lausanne*

Chalet in Crans-Montana *Private Client*

Villa in Crans-près-Céligny *Rytz & Cie SA, Nyon*

Villa in Crans-Montana *savioz fabrizzi architects, Sion*

Villa Tatiana in Crans-près-Celigny *Berset ingénieurs, Remi Tessier Design*

Chalet in Villars *OVA architects, Geneva*

RESTAURANT AND BAR

Montbovon Restaurant, Lausanne *Cotting Jossen Architects, Lausanne*

Hotel in Crans Montana *actescollectif architects, Sierre*

Lele Restaurant, Zürich *Direct Mandate*

FACADES

Building of La Miroiterie, Lausanne *Brauen & Wälchli architects, Lausanne*

St-Georges Center, Geneva *Sauerbruch et Hutton, Berlin*

Terreaux Mauborget Building in Lausanne *Squalli architects, Lausanne*

Rhône 30, Geneva *SPG Geneva*

Artol, Granges-Paccot *Direct Mandate*

SELECTION OF COMPLETED PROJECTS

SCHOOLS AND SPORTS HALLS

Bethusy College, Lausanne *Esposito et Javet architects, Lausanne*

Sport Hall in Borex-Crassier *Mann - Capua-Mann architectes, Lausanne*

Cheseaux School Complex *Mann-Capua-Mann ET Tekhne architects, Lausanne*

La Rippe School Complex *nb architects, Lausanne*

Apples Secondary School *Mann - Capua-Mann architects et Tekhne, Lausanne*

Sport Hall in Mont-sur-Rolle *Ruffieux et Chehab architects, Fribourg*

Drize Orientation Cycle *Brauen & Wälchli architects, Lausanne*

IDHEAP Lausanne *Geninasca et Delefortrie architects, Neuchâtel*

Leman School in Renens *Esposito et Javet architects, Lausanne*

Choll, Nursery and Multipurpose Hall in Chermignon *Frei Rezakhanlou architects, Lausanne*

Estavannens School *RB.CH architects, Bulle*

Brillantmont international school, Multipurpose Hall *Frei Rezakhanlou architects, Lausanne*

College of Rolle *Pahud architects, Rolle*

CO St. Maurice *Mann Capua Mann architects, Lausanne*

Le Mottier School in Le Mont sur Lausanne *Graf et Rouault architects, Lausanne*

DOSF Fribourg *Dettling et Pelleriaux architects, Lausanne*

Censuy School in Renens *Esposito et Javet architects, Lausanne*

Bussigny College *Studio Montagnini Fusaro, Venezia*

Belfaux School *Atelier March, Geneva*

Former Prefecture of Versoix *Cathrin Trebeljahr Architectes, Geneva*



Church of Vicques, Switzerland

SELECTION OF COMPLETED PROJECTS

ÉGLISES ET TEMPLES

Notre Dame de l'Assomption de Courgenay Church *Kury Stählin architects, Delémont*

Notre Dame Vevey Church *Kolecek architects, Lausanne*

Wünnewil Church *Normal office, Fribourg*

St. Marcel Church in Delémont *Kury Stählin architects, Delémont*

St. Rédempteur Church in Lausanne *Frei Rezakhanlou architects, Lausanne*

Vicques Church *Direct Mandate*

Abbey of Payerne *Kolecek architects, Lausanne*

Troistorrents Church *Ab Partenaire, Lausanne*

Abbey of Maigrauge *Direct Mandate*

Mosnatery of Estavayer-le-lac *Direct Mandate*

Bex Church *DT Architect, Bex*

HOMES, NUSERY HOMES AND HOSPITALS

Patient Admission of Biel Hospital *Robert Schmid, Bienne*

Frsa Marmettes Center *Pont 12 Architects, Lausanne*

« **La paix du soir** » **Nursing Home, Mont-sur-Lausanne** *Boschetti architects, Lausanne*

« **Signal** » **Nursing Home, Lausanne** *Esposito et Javet architects, Lausanne*

Rive Neuve Foundation *Brauen & Wälchli architects, Lausanne*

« **Le Marronnier** » **Nursing Home, Lutry** *Esposito et Javet architects, Lausanne*

HFR Riaz *RBCH architectes, La Tour de Trème*

Béthanie Institution, Lausanne *Tribu architects, Lausanne*

« **la Rosavère** » **Nursing Home, Lausanne** *Boschetti architects, Lausanne*

« **Beausobre** » **Nursing Homes, Morges** *Troisplus architects, atelier Arthys, Lausanne*

Vernand Foundation *Mann Capua Mann architects, Lausanne*

Affidea Carouge And Viège, Diagnostic Center *Concept Consult Design, Lausanne*

« **les Fauvettes** » **Nursing Home** *Esposito et Javet architects, Lausanne*

« **la Rozavère** » **Nursing Home** *Juan Socas Architect, Morges*



Rolex in Bienne, Switzerland

A&B
lightdesignagency

Rue du Valentin 30
1004 Lausanne
eclairage@aebischer-bovigny.ch
+41 21 320 96 48
www.aebischer-bovigny.ch